

Second Floor

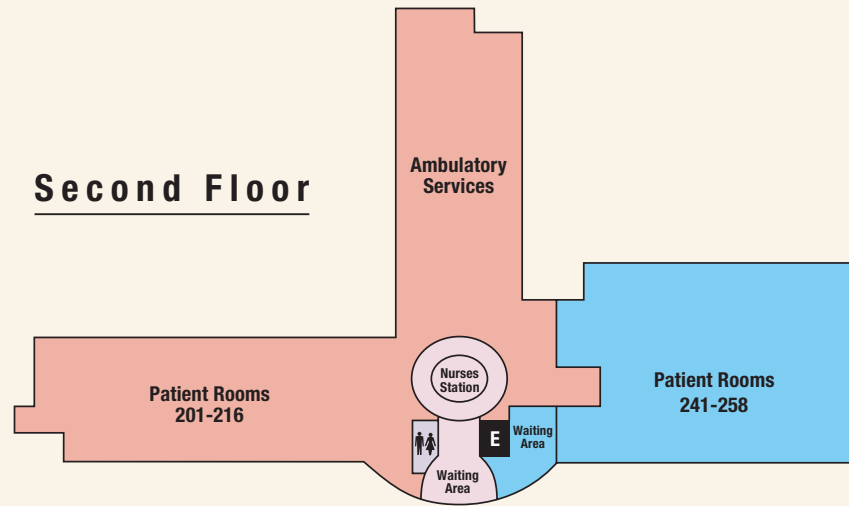

Third Floor

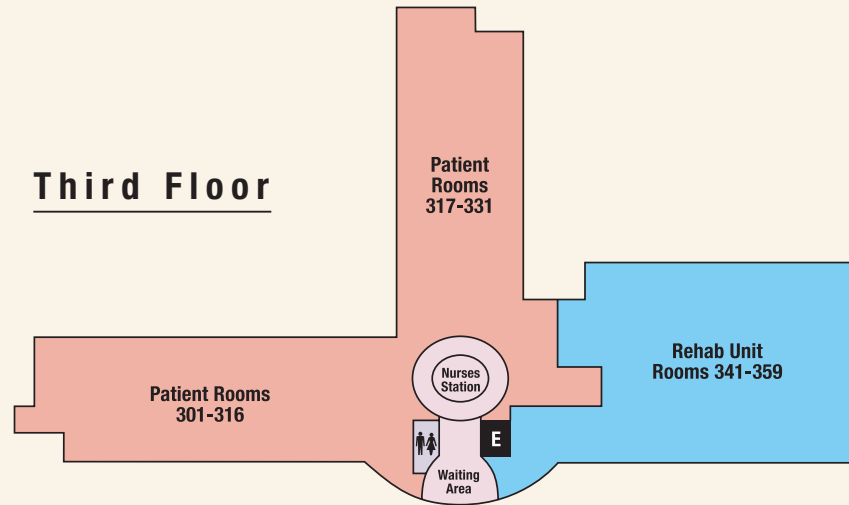

Fourth Floor

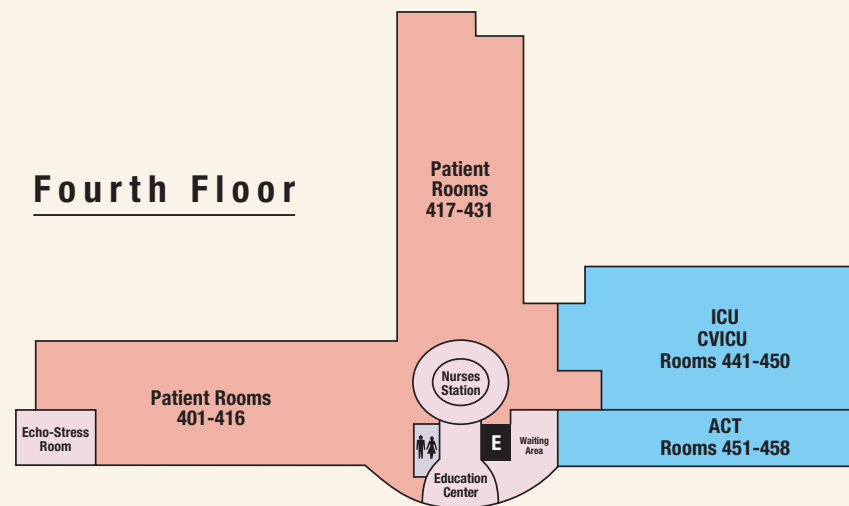

Legend

E Elevators

 Restrooms

VISITOR INFORMATION

Visiting Hours – Main Hospital

8 a.m. – 8 p.m. Children, under age 12, may visit from 5 p.m. – 7 p.m. when accompanied by an adult and with the authorization of the patient's nurse.

Visiting Hours – Intensive Care Unit

Visitation in the ICU may vary. Visitation and phone calls are restricted from 6 a.m. – 8 a.m. and from 6 p.m. – 8 p.m. Visitors are limited to immediate family ages 12 and older. For visitation guidelines, please speak with the ICU Nurse.

Lantanas Café

Monday – Friday
Breakfast: 6:50 a.m. – 10 a.m.
Lunch: 11 a.m. – 2 p.m.

Vending area open 24 hours.

Courtesy Phones

At each information desk; please limit calls to 3 minutes or less.

Chapel

Open to all visitors and patients, located on the 1st floor near the elevators.

Chaplain

Dial "0" and ask to have a chaplain paged.

Gift Shop

Monday – Friday 9:30 a.m. – 2:30 p.m.

Security

Dial "0" on the courtesy phone.

Cell Phones

Use of cellular devices inside the main hospital is not permitted.



ORO VALLEY HOSPITAL





ORO VALLEY HOSPITAL

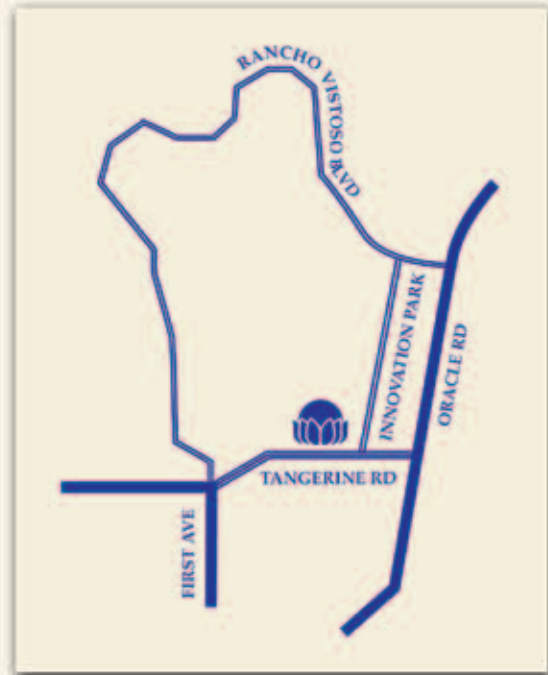

Take Tangerine Road west from Oracle Road. The hospital site is approximately 1/4 mile from Oracle Road on the north side of Tangerine Road.

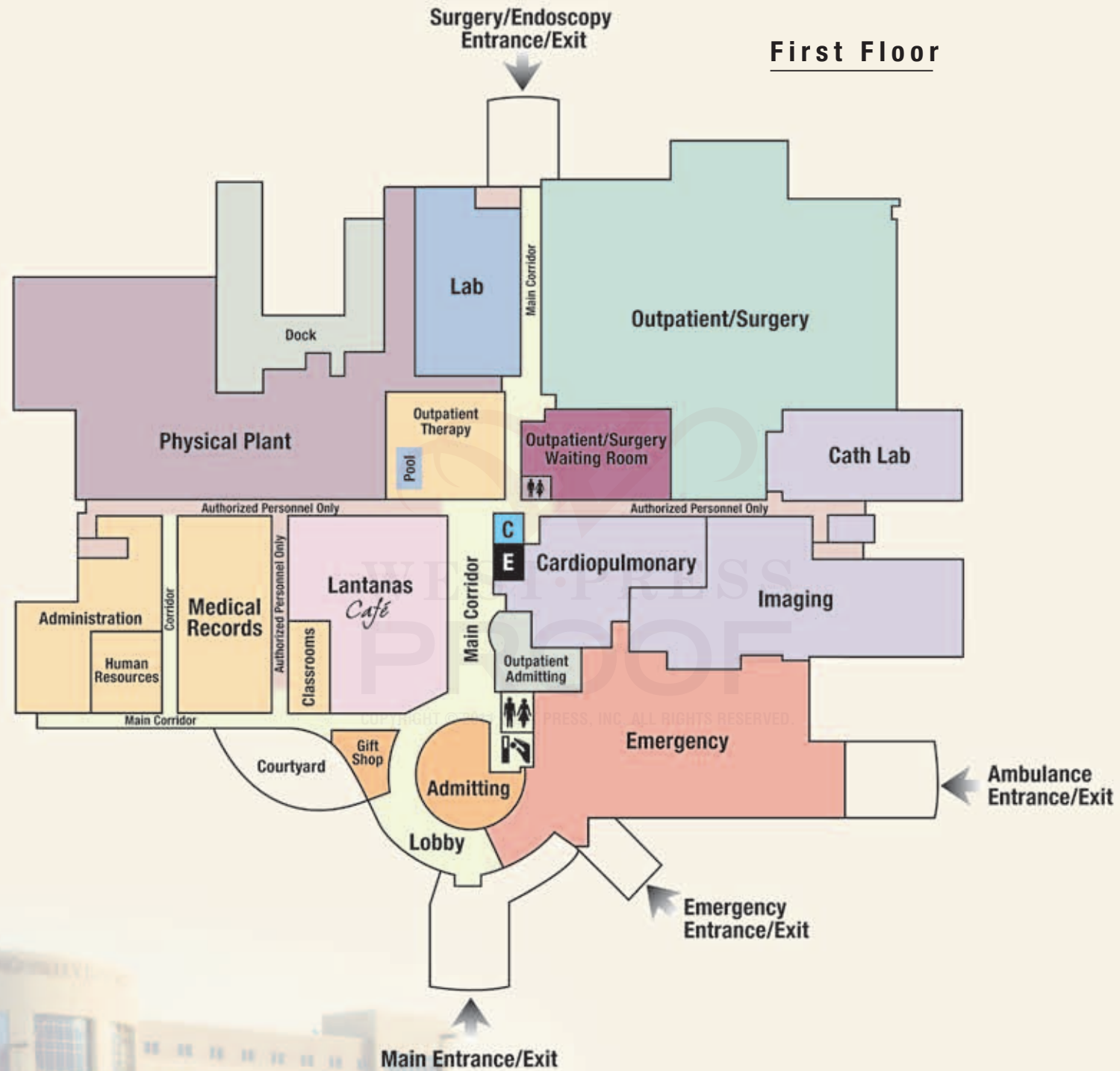

FREQUENTLY CALLED NUMBERS

Hospital Switchboard	901-3500
Central Scheduling	469-8810
Senior Circle	469-8194
Administration	901-3549
Emergency Department	901-3510
Human Resources	901-3554
Medical Records	901-3560
Patient Accounts (Cashier)	901-3920
Patient Registration (Admitting)	901-3514
Physician Referral	866-NW4WELL (866-694-9355)
Pre-Admissions	901-3676
Rancho Vistoso Urgent Care	818-2000
Volunteers	901-3631

First Floor Legend

- Elevators
- Restrooms
- Chapel
- Vending
- Main Corridor

